



HEKO
GROUP
CONVEYOR SOLUTIONS



HEKO chain shackles DIN 745, DIN 5699 and S

Technological characteristics for chain shackles

HEKO chain shackles are exactly matched to the selected chain execution. This applies to the material quality and hardening depth. For high wear requirements, it is possible to choose between several inductive or case hardened chain executions.

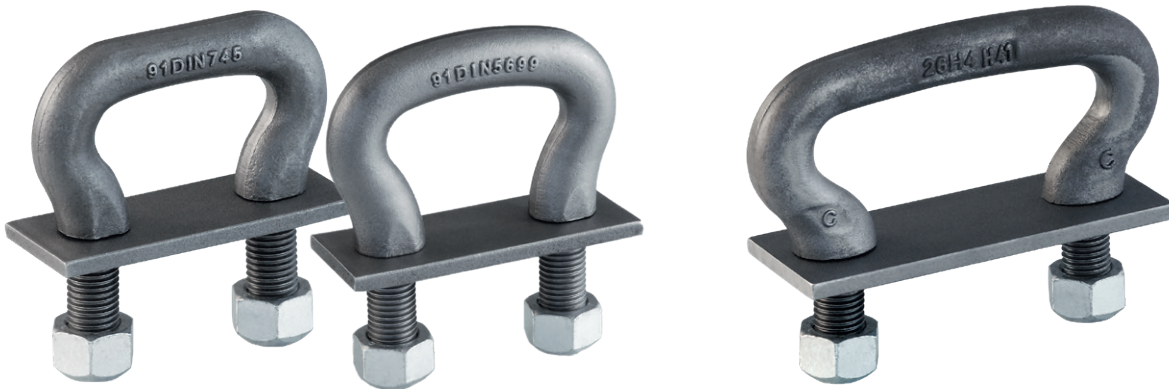

Chain shackle type DIN 5699 and type DIN 745

- Simple to install
- For chains to DIN 764/766 and works standard
- Suitable for toothed wheels with equal chain pitch, otherwise use toothless wheels
- Shackles have to be used with distance plate and safety element

Chain shackle type S

- Simple to install
- For chains to DIN 764/766 and works standard
- Suitable only with toothless wheels
- Shackles have to be used with distance plate and safety element
- Less wear due to bigger pitch



HEKO chain shackles DIN 745, DIN 5699 and S

Tempered Steel, Chrome-Molybdenum or
Chrome-Nickle Steel Shackles

	Hardened contact area qualities		Case hardened qualities
	Heat treatable steel	CrMo-steel	CrNi-steel
	HEKO 41	HEKO 42	HEKO 5
Proof stress N/mm ²	125	240	150
Breaking stress N/mm ²	280	400	370 ₄₎
Contact surface hardness min. joint HV 1	600	600	750
Hardening depth d min. after etching	0.1 ₁₎	0.12 ₁₎	0.1 ₁₎
Hardening depth d min. CHD ₂₎ Rht ₃₎ 550 HV 1	0.06	0.07	0.06

1) tolerance d-0,01d

2) CHD = case hardened depth

3) Rht = hardening depth

4) tolerance - 10% > T=105 = -20%

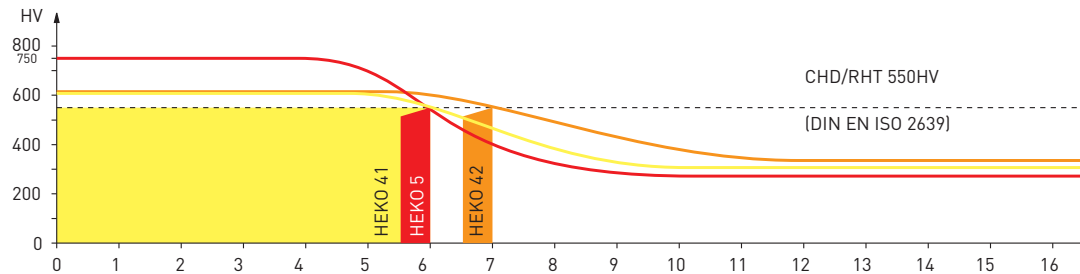

Hardening depth in % - diameter from surface

Technical data and qualities for HEKO chain shackles as per DIN 745

pitch (mm)	weight shackle with 2 nuts [kg/each]	weight plate [kg/each]	chain shackle dimensions (mm)						plate dimensions (mm)				HEKO qualities hardened contact areas					
			b ₂	d ₂	d ₁	h	a	l	L	D	S	B	HEKO 41	HEKO 42	HEKO 5			
t	[kg/each]	[kg/each]																
45	0.19	0.08	11.5	14	M10	40	20	25	75	30	5	10.5	76	106	98			
56	0.39	0.17	15.0	18	M12	50	25	32	95	40	6	13.0	115	161	149			
63	0.67	0.20	18.0	21	M16	60	30	40	110	40	6	17.0	145	203	188			
70	1.03	0.25	20.0	23	M20	68	34	45	120	50	6	21.0	179	251	232			
80	1.26	0.28	23.0	26	M20	74	37	45	130	50	6	21.0	237	331	307			
91	2.03	0.50	26.0	29	M24	86	43	55	150	60	8	25.0	303	425	393			
105	2.60	0.56	30.0	34	M24	100	50	55	165	60	8	25.0	403	565	523			
126	4.42	1.00	36.0	40	M30	118	59	70	200	70	10	31.0	580	814	753			
147	6.07	1.10	42.0	46	M30	136	68	70	220	70	10	31.0	790	1108	1025			
147	7.33	1.53	42.0	46	M36	136	68	85	230	80	12	37.0	790	1108	1025			

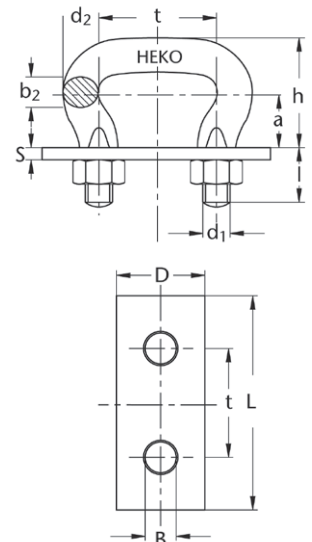

MBK = min. breaking load, t = pitch, d = diameter. When employing toothed chain wheels chain pitch and shackle pitch must be the same. When employing toothless chain wheels the pitch of shackles can be one size larger than chain pitch. Additional qualities available on request.

