

# BFK pan conveyors HEKO chains with / without brackets

The often particularly long and highly stressed steel cell conveyors place significant demands on the specialist, high-quality chain equipment in use. HEKO offers you here its high-performance bush conveyor chains. The chains are manufactured exclusively in HEKO's own production facilities. The robust design, the precise workmanship and the high-quality steels in use guarantee a reliable operation and a long service life of the chains.

The HEKO angle brackets are made by using precisely working bending tools and machines. The cams on the inner and outer link plates are required to stiffen the chain under load and prevent direct contact between the overlaps of the band segments. The high-quality case hardening of the pins and bushings ensures a significant reduction in chain wear.

HEKO does not only manufacture bush conveyor chains according to DIN 8165, DIN 8175 with financial pitches of 160 mm, 200 mm, 250 mm and 315 mm as well as according to customer requirements also northwards according to the standard of Bush conveyor chains with 250 mm pitch and strand lengths of 500, 1000, 1500 and 2000 mm. In thought The HEKO bush conveyor chains will belong to the conveyor in the two designs:

- HEKO bush chains for pan conveyor
- HEKO bush chains for deep drawn bucket conveyor



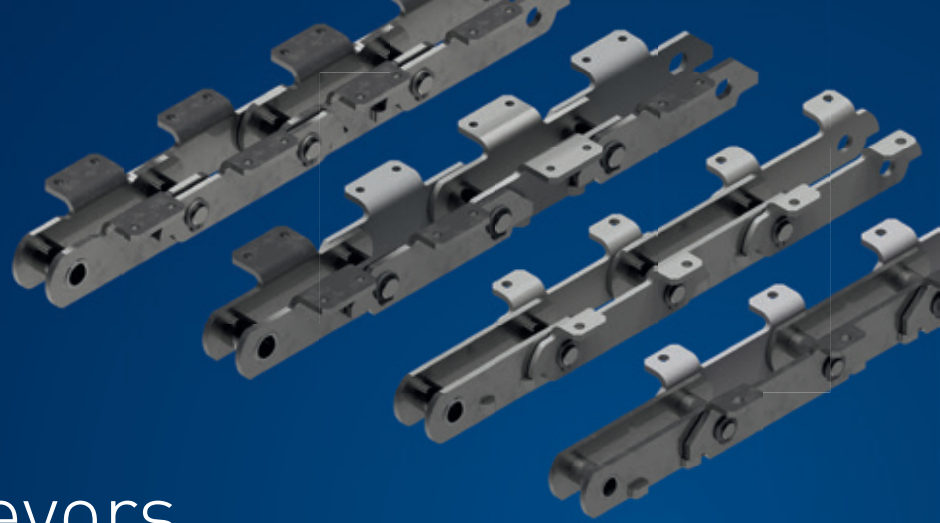

# BFK pan conveyors HEKO chains with / without brackets

## HEKO bush chains for pan conveyors

In the design as a bush conveyor chain for apron conveyors, the inner and outer plates do have attachment plates on which the pans are fixed. According to the individual installation those attachments can be on one or on both sides of the chain link. It is possible to design the pan conveyors with a single-strand chain or a double-strand chain, depending on factors such as capacity, pan width etc.

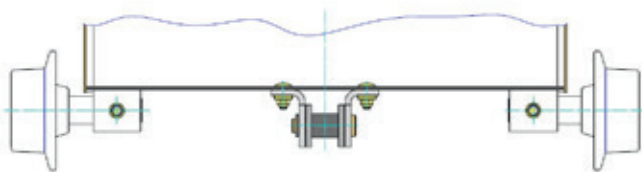

Single-strand chain

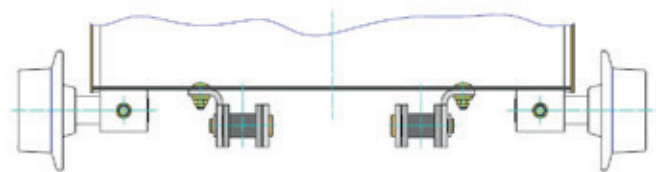

Double-strand chain with attachment on one side

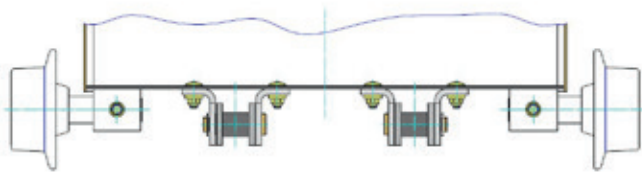

Double-strand chain with attachment on both sides

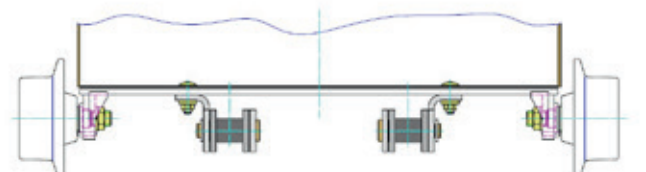

Double-strand chain with bracket

Double-strand chains with brackets are a special design  
The additionally installed brackets ensure a perfect stabilization  
of the chain and the pans during operation.

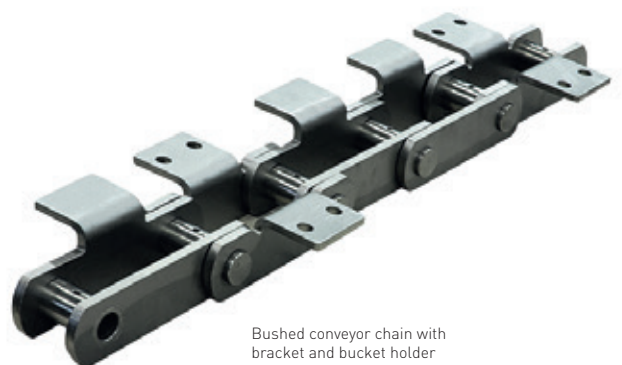

Bushed conveyor chain with  
bracket and bucket holder

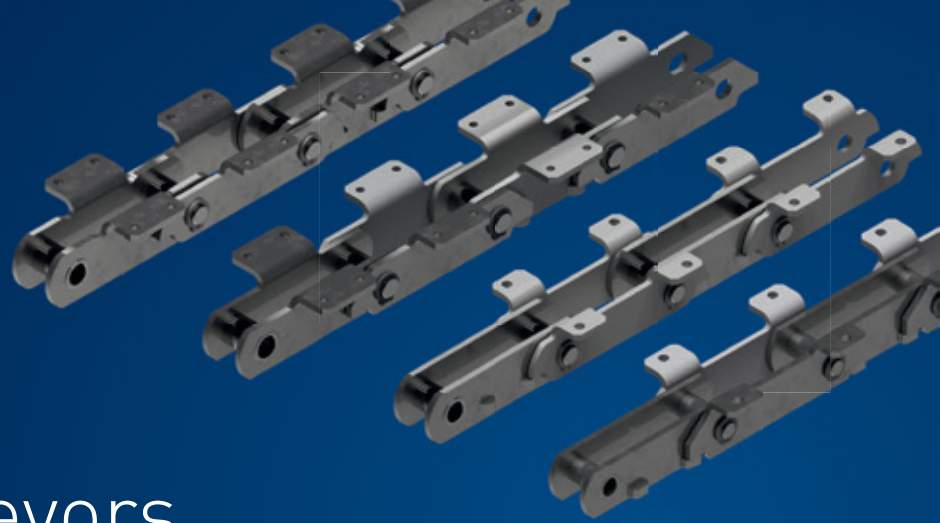

# BFK pan conveyors HEKO chains with / without brackets

Most of the pan conveyor chains are supplied with head pins – and locking ring on the opposite side. Flattenings in the area of chain link bores, bushes and pins ensure a reliable operation and protection against the rotation of those important chain elements. Defined press fits between bolts and outer plates as well as bushings and inner plates guarantee a high fatigue strength and a smooth operation.

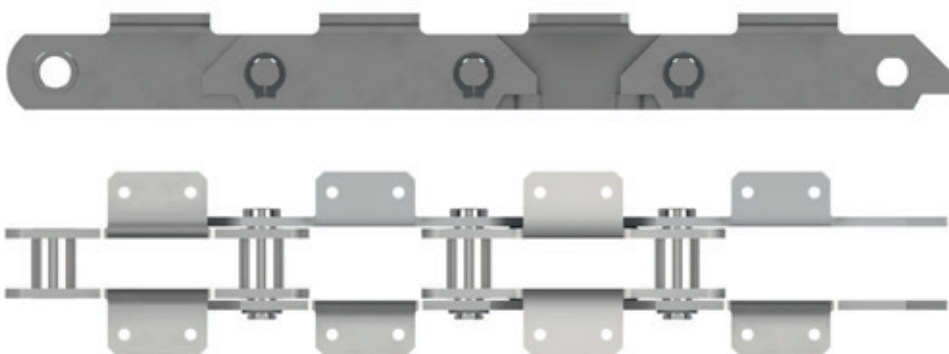

Pan conveyor chain with head pin

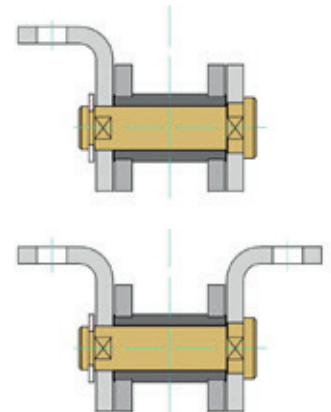

Chain section with head pin

## Standard HEKO pan conveyor chain with head pin

chain type	dimensions (mm)					MBK [kN]
	pitch	inner width	size of side plate	bushing Ø	head pin Ø	
AFP50x8	250	30	50x 8	32	20	220
AFP65x10	250	45	65x10	40	26	400
AFP70x10	250	45	70x10	40	26	450
AFP80x10	250	60	80x10	40	26	520
AFP90x12	250	60	90x12	44	30	700
AFP90x12V	250	60	90x12	54	36	900
PC220	250	30	50x 8	32	20	220
PC450	250	45	70x10	40	26	450
PC520	250	60	80x10	40	26	520
PC700	250	60	90x12	44	30	700
PC900	250	60	90x12	54	36	900

Further dimensions and qualities on request. MBK = min. breaking load

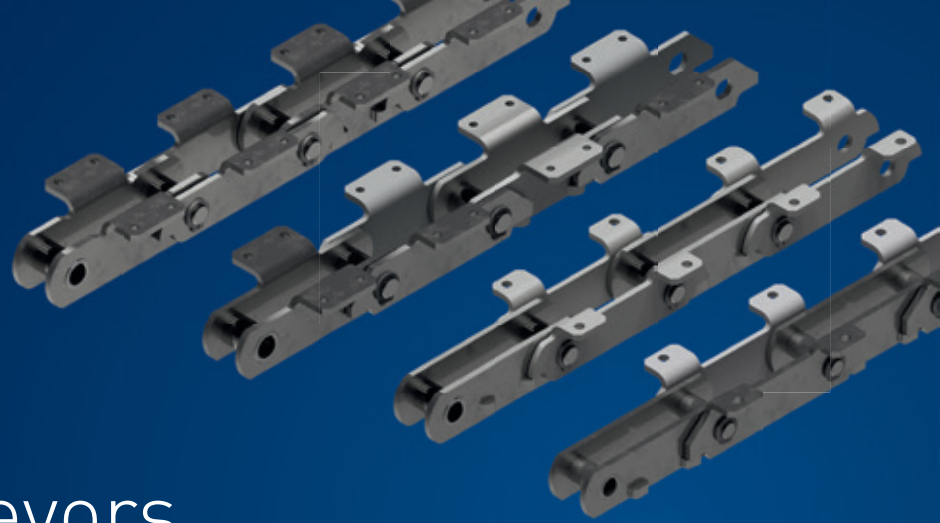

# BFK pan conveyors HEKO chains with / without brackets

Bush chains with a locking ring on both sides. For easy installation we supply the last pin of each strand as head pin. Flattenings in the area of chain link bores, bushes and pins ensure a reliable operation and protection against the rotation of those important chain elements. A flattening in the area of the tab seat on the socket as well as in the corresponding bores of the inner plate guaranteed in the operational Use reliable protection against the rotation of the bushings. Defined press fits between Bolts and outer plates as well as bushings and inner plates guarantee a high.

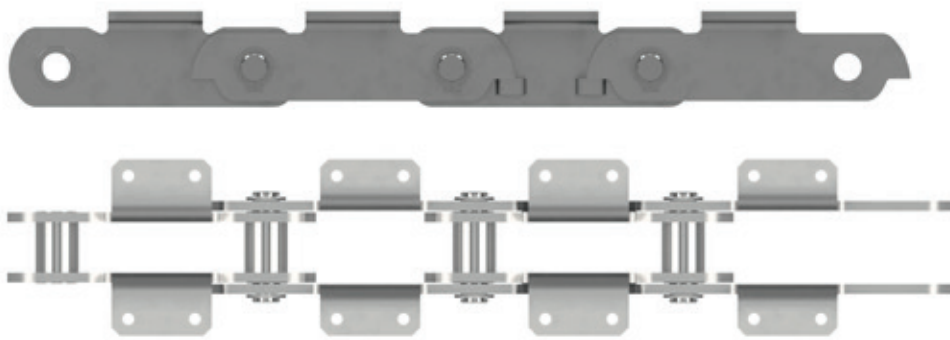

Bush chains with locking ring on both sides of the pin

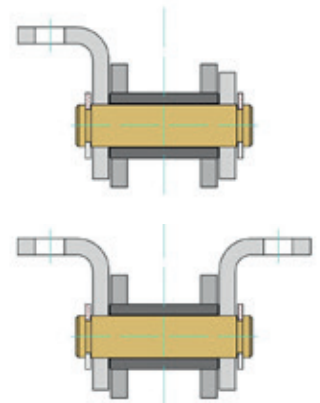

Chain section with a locking ring on both sides of the chain

## Standard HEKO pan conveyor chain with a locking ring on both sides of the pin

chain type	pitch	inner width	dimensions (mm)			MBK (kN)
			size of side plate	bushing Ø	head pin Ø	
PCS290	250	30	45/55x8	32	20	290
PCS510	250	45	65/75x10	40	26	510
PCS700	250	55	70/85x12	44	30	700
PCS900	250	60	85/100x12	52	34	900

Further dimensions and qualities on request. MBK = min. breaking load

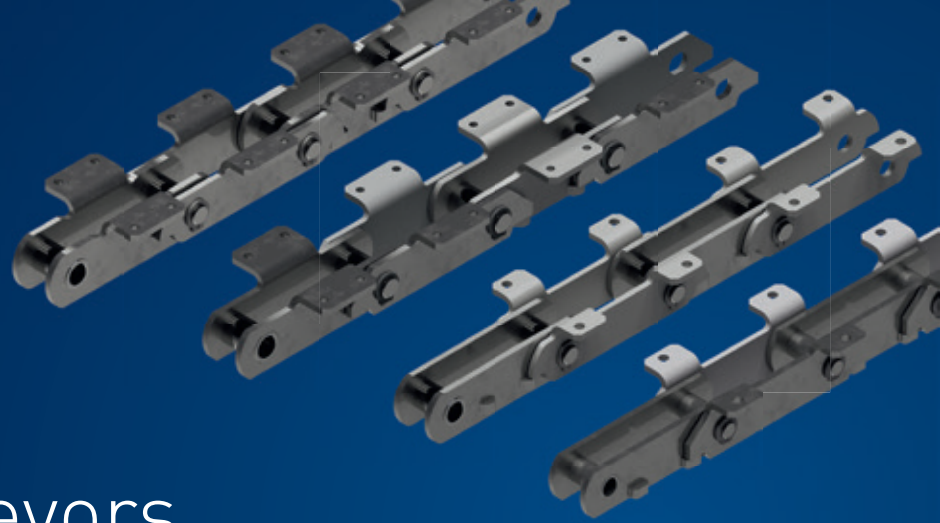

# BFK pan conveyors HEKO chains with / without brackets

## HEKO bush conveyor chains for deep drawn bucket conveyors

In the design as a bush conveyor chain for deep drawn bucket conveyors, the outer plates have two angle elements on one side, to which the buckets are attached. Depending on the version of conveyor, there are chains with angle element only at the outside or also at the inner side of the outer chain link. In general, there are chains which run as a single-strand or as double-strand execution.

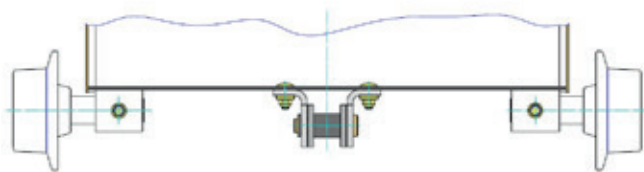

Single-strand chain

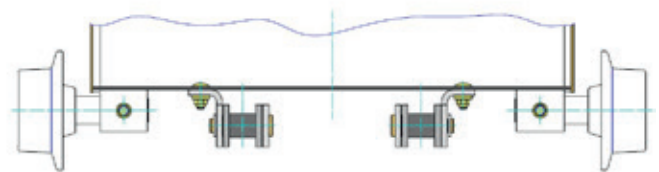

Double-strand chain with angle element on one side

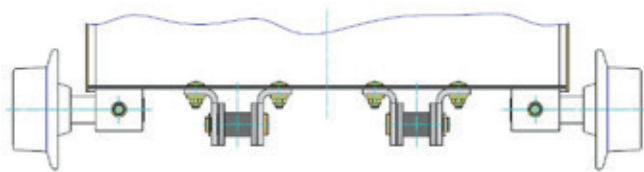

Double-strand chain with angles elements on both sides

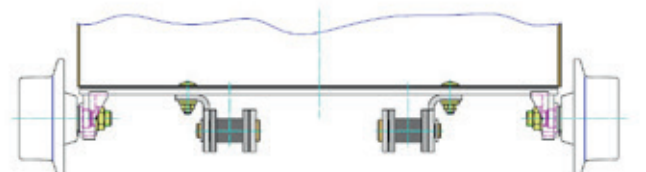

Double-strand chain with bracket

Double-strand chains with a bracket are a special design. Here, the angle elements are bended in higher and lower version on the inner and outer plates. The pans are attached together with the so-called bracket to the low angle element and support themselves over the additional high angle elements on the chain.



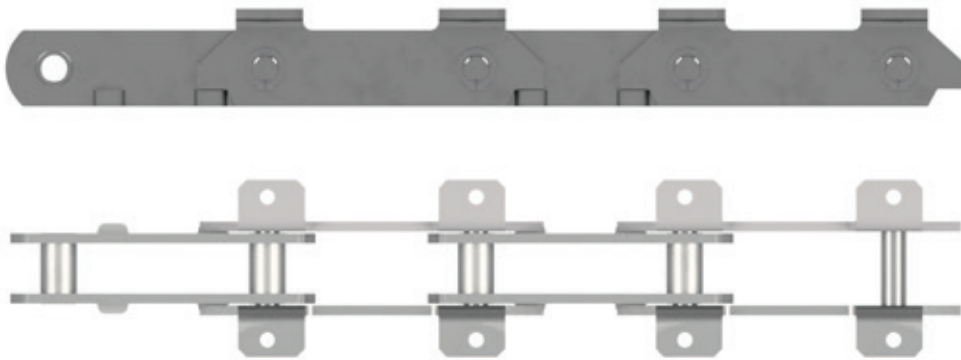

Deep drawn bucket conveyor chain with head pin

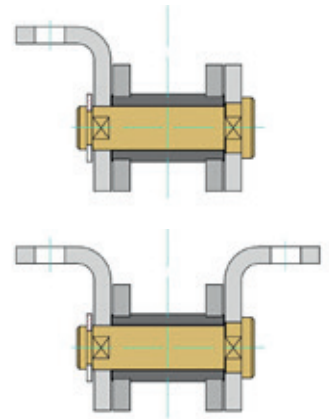

Chain section of chain with head pin

### Standard HEKO chain for deep drawn bucket conveyor with head pin

chain type	pitch	inner width	dimensions (mm)			MBK [kN]
			size of side plate	bushing Ø	head pin Ø	
AFB50x8	250	30	50x8	32	20	220
AFB65x10	250	45	65x10	40	26	400
AFB70x10	250	45	70x10	40	26	450
AFB 80x10	250	60	80x10	40	26	520
AFB90x12	250	60	90x12	44	30	700
AFB90x12V	250	60	90x12	54	36	900
BC220	250	30	50x8	32	20	220
BC450	250	45	70x10	40	26	450
BC520	250	60	80x10	40	26	520
BC700	250	60	90x12	44	30	700
BC900	250	60	90x12	54	36	900

Further dimensions and qualities on request. MBK = min. breaking load

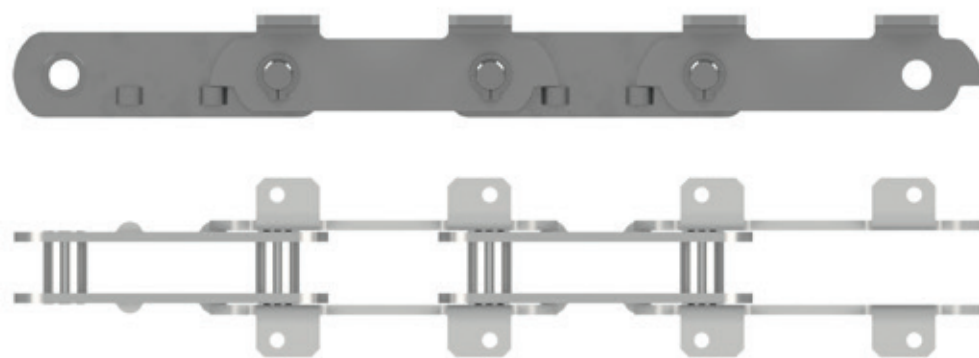

Deep drawn bucket conveyor chain with a locking ring on both sides of the pin

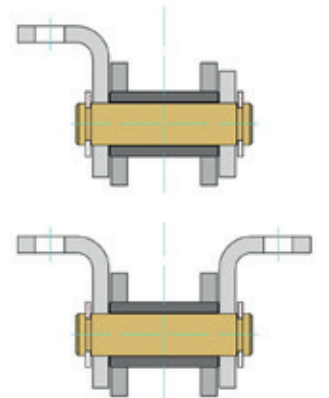

Chain section with a locking ring on both sides of the chain

### Standard HEKO chain for deep drawn bucket conveyor

chain type	pitch	inner width	dimensions (mm)			MBK [kN]
			size of side plate	bushing Ø	head pin Ø	
BCS290	250	30	45/55x8	32	20	290
BCS510	250	45	65/75x10	40	26	510
BCS700	250	55	70/85x12	44	30	700
BCS900	250	60	85/100x12	52	34	900

Further dimensions and qualities on request. MBK = min. breaking load